

FED. ROAD DIV. NO.	STATE	F A PROJECT NO.	FISCAL YEAR	SHEET NO.
3	FLA.	RS-4854(5)		3

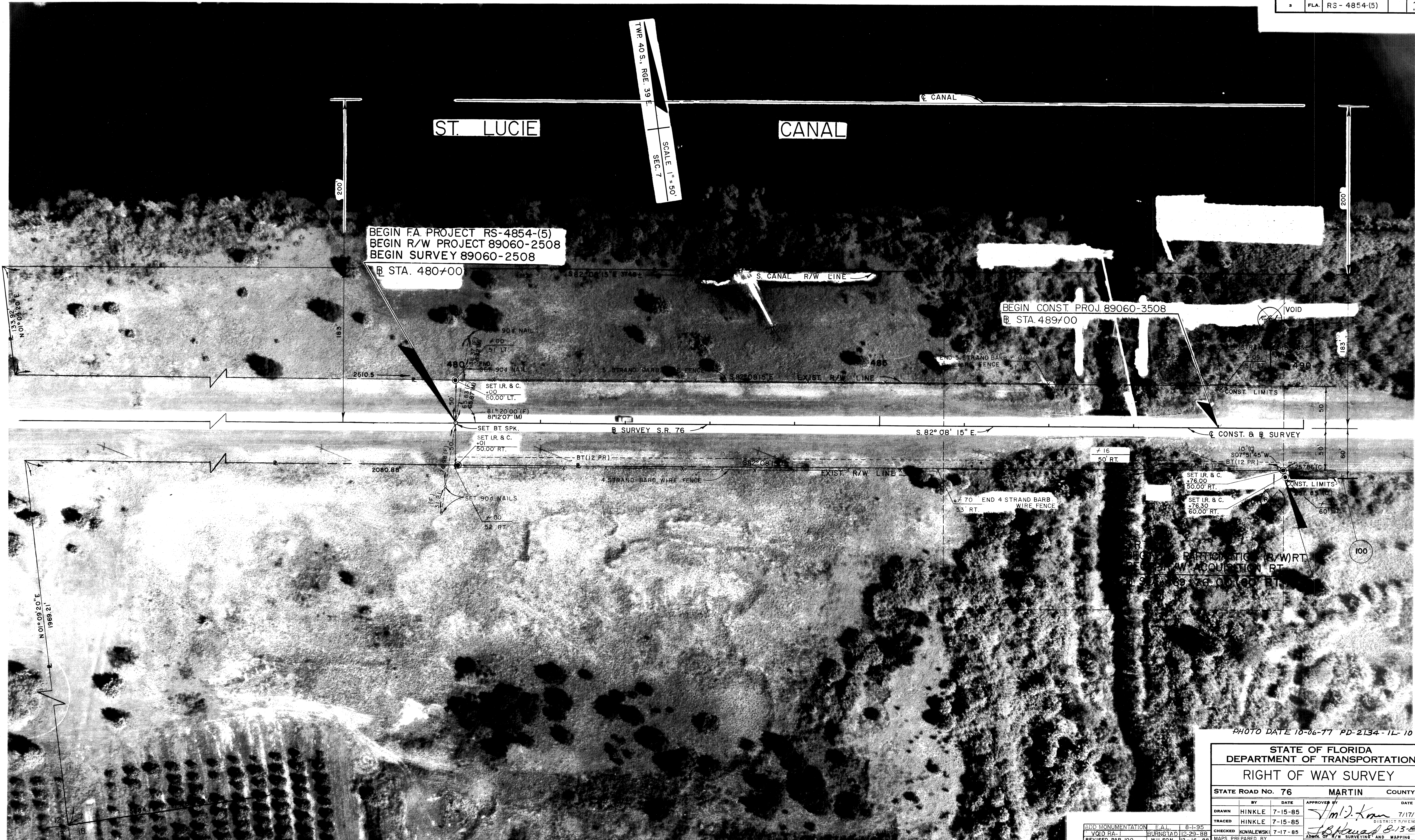

NOTE: ALL DISTANCES AND ANGLES FOLLOWED BY (M) ARE BASED ON FIELD MEASUREMENTS MADE DURING THE R/W MONUMENTATION SURVEY.

(SEE SHEET 1 FOR NOTES, SURVEYOR'S NOTES, & SURVEYOR'S CERTIFICATE)

● DENOTES R/W MARKER (SET I.R. & C.)

PHOTO DATE 10-06-77 PD-2134-1L-10

STATE OF FLORIDA
DEPARTMENT OF TRANSPORTATION
RIGHT OF WAY SURVEY

STATE ROAD NO. 76		MARTIN COUNTY	
DRAWN	HINKLE	DATE	7-15-85
TRACED	HINKLE	DATE	7-15-85
CHECKED	KWALEWSKI	DATE	7-17-85
REVISED PAR 100	WILSON	DATE	12-16-88
ADD SPILLWAY "F"	WATSON	DATE	9-28-87
ADD MONUMENTATION	F.A.L.	DATE	8-1-95
VOID PAR 100	BURNSTAD	DATE	12-23-88

MAPS PREPARED BY: DISTRICT 4
W.P.L. NO. 4116124
ADMN. OF P.M. SURVEYING AND MAPPING
FIELD BOOK NO'S 1009746, 1017764, 1010298, 1018530, 1017763

BY	DATE	APPROVED BY	DATE
HINKLE	7-15-85	<i>M.D. K...</i>	7/17/85
HINKLE	7-15-85		
KWALEWSKI	7-17-85		
WILSON	12-16-88		
WATSON	9-28-87		
F.A.L.	8-1-95		
BURNSTAD	12-23-88		